



## Фитинги с кольцевым торцевым уплотнением ZCO

### Технические характеристики

#### По вопросам продаж и поддержки обращайтесь:

Архангельск +7 (8182) 45-71-35  
Астана +7 (7172) 69-68-15  
Астрахань +7 (8512) 99-46-80  
Барнаул +7 (3852) 37-96-76  
Белгород +7 (4722) 20-58-80  
Брянск +7 (4832) 32-17-25  
Владивосток +7 (4232) 49-26-85  
Владимир +7 (4922) 49-51-33  
Волгоград +7 (8442) 45-94-42  
Воронеж +7 (4732) 12-26-70  
Екатеринбург +7 (343) 302-14-75  
Иваново +7 (4932) 70-02-95  
Ижевск +7 (3412) 20-90-75  
Иркутск +7 (3952) 56-24-09  
Йошкар-Ола +7 (8362) 38-66-61  
Казань +7 (843) 207-19-05

Калининград +7 (4012) 72-21-36  
Калуга +7 (4842) 33-35-03  
Кемерово +7 (3842) 21-56-70  
Киров +7 (8332) 20-58-70  
Краснодар +7 (861) 238-86-59  
Красноярск +7 (391) 989-82-67  
Курск +7 (4712) 23-80-45  
Липецк +7 (4742) 20-01-75  
Магнитогорск +7 (3519) 51-02-81  
Москва +7 (499) 404-24-72  
Мурманск +7 (8152) 65-52-70  
Наб.Челны +7 (8552) 91-01-32  
Ниж.Новгород +7 (831) 200-34-65  
Нижневартовск +7 (3466) 48-22-23  
Нижнекамск +7 (8555) 24-47-85

Новороссийск +7 (8617) 30-82-64  
Новосибирск +7 (383) 235-95-48  
Омск +7 (381) 299-16-70  
Орел +7 (4862) 22-23-86  
Оренбург +7 (3532) 48-64-35  
Пенза +7 (8412) 23-52-98  
Первоуральск +7 (3439) 26-01-18  
Пермь +7 (342) 233-81-65  
Ростов-на-Дону +7 (863) 309-14-65  
Рязань +7 (4912) 77-61-95  
Самара +7 (846) 219-28-25  
Санкт-Петербург +7 (812) 660-57-09  
Саранск +7 (8342) 22-95-16  
Саратов +7 (845) 239-86-35  
Смоленск +7 (4812) 51-55-32

Сочи +7 (862) 279-22-65  
Ставрополь +7 (8652) 57-76-63  
Сургут +7 (3462) 77-96-35  
Сызрань +7 (8464) 33-50-64  
Сыктывкар +7 (8212) 28-83-02  
Тверь +7 (4822) 39-50-56  
Томск +7 (3822) 48-95-05  
Тула +7 (4872) 44-05-30  
Тюмень +7 (3452) 56-94-75  
Ульяновск +7 (8422) 42-51-95  
Уфа +7 (347) 258-82-65  
Хабаровск +7 (421) 292-95-69  
Чебоксары +7 (8352) 28-50-89  
Челябинск +7 (351) 277-89-65  
Череповец +7 (8202) 49-07-18  
Ярославль +7 (4852) 67-02-35

сайт: [hylok.pro-solution.ru](http://hylok.pro-solution.ru) | эл. почта: [hky@pro-solution.ru](mailto:hky@pro-solution.ru)

телефон: 8 800 511 88 70

## Гайки

### Гайка

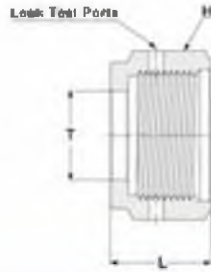

Part Number	ZCO Size in	L		H Hex Flat
		in. (mm)		
H-ZCOFN - 4	1/4	0.66 [16.76]	0.40 [10.16]	11/16"
H-ZCOFN - 8	1/2	0.69 [17.53]	0.61 [15.49]	1"
H-ZCOFN - 12	3/4	0.81 [20.57]	0.94 [23.88]	1-1/2"
H-ZCOFN - 16	1	0.81 [20.57]	1.25 [31.75]	1-3/4"

### Заглушка



Part Number	ZCO Size in	L		H Hex Flat
		in. (mm)		
H-ZCOBN - 4	1/4	0.44 [11.18]		11/16"
H-ZCOBN - 8	1/2	0.56 [14.22]		1"
H-ZCOBN - 12	3/4	0.75 [19.05]		1-1/2"
H-ZCOBN - 16	1	0.81 [20.57]		1-3/4"

## Вставки (адаптеры трубок под соединение ZCO)

### Приварной конец

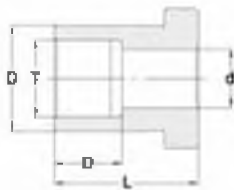

Part Number	ZCO Size in	T Tube O.D.	D	d	L	L <sub>2</sub>	Working Pressure	
							psig	bar
H-ZCOSWG - 2	1/8	1/8"	0.38 [9.65]	0.09 [2.29]	0.77 [19.56]	0.10 [2.54]	15400	1060
H-ZCOSWG - 4	1/4	1/4"	0.38 [9.65]	0.18 [4.57]	0.77 [19.56]	0.28 [7.11]	6800	460
H-ZCOSWG - 6	1/2	3/8"	0.60 [15.24]	0.28 [7.11]	0.81 [20.57]	0.31 [7.87]	8100	560
H-ZCOSWG - 8	1/2	1/2"	0.60 [15.24]	0.40 [10.16]	0.81 [20.57]	0.38 [9.65]	3000	200
H-ZCOSWG - 12	3/4	3/4"	0.92 [23.37]	0.62 [15.75]	0.94 [23.88]	0.44 [11.17]	3700	250
H-ZCOSWG - 16	1	1"	1.19 [30.23]	0.87 [22.10]	0.98 [24.90]	0.62 [15.75]	3000	200

### Вставка под автоматическую приварку

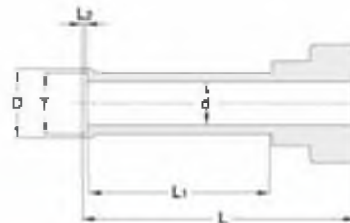

Part Number	ZCO Size in	T Tube O.D.	D	d	L	L <sub>1</sub>	L <sub>2</sub>	Nominal Wall Thickness	Working Pressure	
									psig	bar
H-ZCOTWG- 4A	1/4	1/4"	0.29 [ 7.37]	0.18 [ 4.57]	1.12 [28.45]	0.75 [19.05]	0.02 [0.51]	0.035"	5100	350
H-ZCOTWG- 6A	1/2	3/8"	0.41 [10.41]	0.31 [ 7.87]	1.13 [28.70]	0.75 [19.05]	0.03 [0.76]	0.035"	3300	220
H-ZCOTWG- 8A	1/2	1/2"	0.55 [13.97]	0.40 [10.16]	1.14 [28.96]	0.75 [19.05]	0.04 [1.02]	0.049"	3500	240
H-ZCOTWG-12A	3/4	3/4"	0.80 [20.32]	0.65 [16.51]	1.20 [30.48]	0.75 [19.05]	0.04 [1.02]	0.049"	2100	150
H-ZCOTWG-16A	1	1"	1.06 [26.92]	0.87 [22.10]	1.41 [35.81]	0.96 [24.38]	0.04 [1.02]	0.065"	2100	150

### Приварной адаптер понижающий

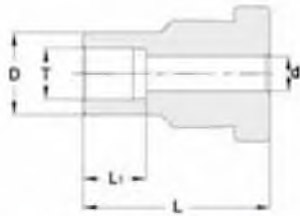

### Пробка



Part Number	ZCO Size in	T Tube O.D.	in. (mm)				Working Pressure	
			D	d	L	L <sub>1</sub>	psig	bar
H-ZCOSWRG-4-2	1/4	1/8"	0.29 (7.37)	0.09 (2.29)	0.77 (19.56)	0.10 (2.54)	12600	860
H-ZCOSWRG-8-4	1/2	1/4"	0.48 (12.19)	0.18 (4.57)	0.81 (20.57)	0.28 (7.11)	10700	730

Part Number	ZCO Size in	in. (mm)	
		D	L
H-ZCOBG- 4	1/4	0.38 ( 9.65)	0.44 (11.18)
H-ZCOBG- 8	1/2	0.60 (15.24)	0.44 (11.18)
H-ZCOBG- 12	3/4	0.92 (23.37)	0.50 (12.7 )
H-ZCOBG- 16	1	1.19 (30.23)	0.50 (12.7 )

### Корпуса

#### Соединитель под приварку

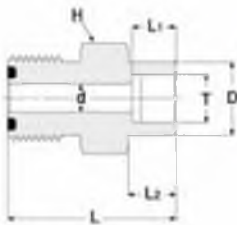

Part Number	ZCO Size in	T Tube O.D.	in. (mm)					H Hex Flat	Working Pressure	
			D	d	L	L <sub>1</sub>	L <sub>2</sub>		psig	bar
H-ZCOSWC- 2	1/8	1/8"	0.29 (7.37)	0.09 (2.29)	0.88 (22.35)	0.10 (2.54)	0.10 (2.54)	5/8"	12600	860
H-ZCOSWC- 4	1/4	1/4"	0.38 (9.65)	0.18 (4.57)	1.09 (27.69)	0.28 (7.11)	0.31 (7.87)	5/8"	6800	460
H-ZCOSWC- 6	1/2	3/8"	0.60 (15.24)	0.28 (7.11)	1.28 (32.51)	0.31 (7.87)	0.38 (9.65)	15/16"	8100	560
H-ZCOSWC- 8	1/2	1/2"	0.73 (18.50)	0.40 (10.16)	1.34 (34.04)	0.38 (9.65)	0.44 (11.18)	15/16"	3000	200
H-ZCOSWC- 12	3/4	3/4"	0.92 (23.37)	0.62 (15.75)	1.50 (38.10)	0.44 (11.18)	0.50 (12.7)	1-5/16"	3700	250
H-ZCOSWC- 16	1	1"	1.19 (30.23)	0.87 (22.10)	1.72 (43.69)	0.62 (15.75)	0.69 (17.53)	1-5/8"	3000	200

#### Соединитель под автоматическую сварку

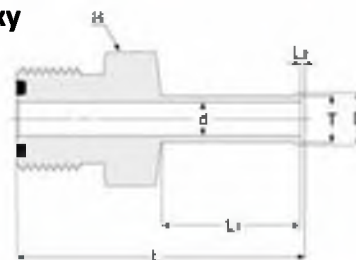

Part Number	ZCO Size in	T Tube O.D.	in. (mm)					H Hex Flat	Nominal Wall Thickness	Working Pressure	
			D	d	L	L <sub>1</sub>	L <sub>2</sub>			psig	bar
H-ZCOTWC- 4A	1/4	1/4"	0.29 ( 7.37)	0.18 ( 4.57)	1.59(40.39)	0.75(19.05)	0.02(0.51)	5/8"	0.035"	5100	350
H-ZCOTWC- 6A	1/2	3/8"	0.41(10.41)	0.31( 7.87)	1.74(44.20)	0.75(19.05)	0.03(0.76)	15/16"	0.035"	3300	220
H-ZCOTWC- 8A	1/2	1/2"	0.55(13.97)	0.40(10.16)	1.75(44.45)	0.75(19.05)	0.04(1.02)	15/16"	0.049"	3500	240
H-ZCOTWC- 12A	3/4	3/4"	0.80(20.32)	0.65(16.51)	1.78(45.21)	0.75(19.05)	0.04(1.02)	15/16"	0.049"	2200	150
H-ZCOTWC- 16A	1	1"	1.06(26.92)	0.87(22.01)	2.03(51.56)	0.96(24.38)	0.04(1.02)	1-5/8"	0.065"	2200	150

### Соединитель с наружной конической резьбой

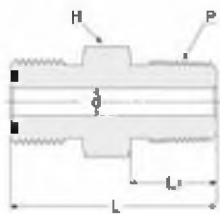

Part Number	ZCO Size In	P Male NPT Size	d	L	L <sub>1</sub>	H Hex Flat	Working Pressure	
							psig	bar
H-ZCOMC 4- 2N	1/4	1/8"	0.18[ 4.57]	1.16[29.46]	0.38[ 9.65]	5/8"	10000	680
H-ZCOMC 4- 4N	1/4	1/4"	0.18[ 4.57]	1.34[34.04]	0.56[14.22]	5/8"	13400	920
H-ZCOMC 8- 6N	1/2	3/8"	0.38[ 9.65]	1.46[37.08]	0.56[14.22]	15/16"	7800	530
H-ZCOMC 8- 8N	1/2	1/2"	0.40[10.16]	1.65[41.91]	0.75[19.05]	15/16"	10000	680
H-ZCOMC12-12N	3/4	3/4"	0.62[15.75]	1.75[44.45]	0.75[19.05]	1-5/16"	7300	500
H-ZCOMC16-16N	1	1"	0.87[22.10]	1.97[50.04]	0.94[23.88]	1-5/8"	5300	360

### Соединитель с наружной резьбой SAE/MS

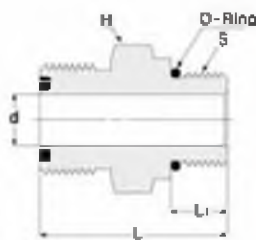

Part Number	ZCO Size In	S Thread Size	d	L	L <sub>1</sub>	H Hex Flat	O-ring Uniform size Number	Working Pressure	
								psig	bar
H-ZCOSC 4- 2U	1/4	7/16-20	0.18[ 4.57]	1.24[31.50]	0.36[ 9.14]	11/16"	-904	4500	310
H-ZCOSC 4- 6U	1/4	9/16-18	0.18[ 4.57]	1.17[29.72]	0.39[ 9.91]	11/16"	-906	4500	310
H-ZCOSC 8- 4U	1/2	7/16-20	0.18[ 4.57]	1.36[34.54]	0.36[ 9.14]	15/16"	-904	4500	310
H-ZCOSC 8- 6U	1/2	9/16-18	0.30[ 7.60]	1.39[35.31]	0.39[ 9.91]	15/16"	-906	4500	310
H-ZCOSC 8- 8U	1/2	3/4-16	0.40[10.16]	1.47[37.34]	0.44[11.18]	1"	-908	4500	310
H-ZCOSC12-12U	3/4	1-1/16-12	0.62[15.75]	1.73[43.94]	0.59[14.99]	1-3/8"	-912	3600	240
H-ZCOSC16-16U	1	1-5/16-12	0.85[21.60]	1.79[45.47]	0.59[14.99]	1-5/8"	-916	2900	190

### Соединитель с внутренней NPT резьбой

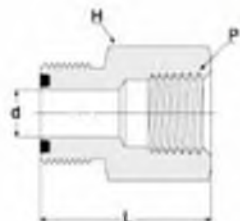

Part Number	ZCO Size In	P Female NPT Size	d	L	H Hex Flat	Working Pressure	
						psig	bar
H-ZCOFC 4- 2N	1/4	1/8"	0.18[ 4.57]	1.25[31.75]	5/8"	8400	570
H-ZCOFC 4- 4N	1/4	1/4"	0.18[ 4.57]	1.39[35.31]	3/4"	6600	450
H-ZCOFC 8- 6N	1/2	3/8"	0.40[10.16]	1.57[39.88]	15/16"	6600	450
H-ZCOFC 8- 8N	1/2	1/2"	0.40[10.16]	1.77[44.96]	1-1/16"	4900	330
H-ZCOFC12-12N	3/4	3/4"	0.62[15.75]	1.93[49.02]	1-5/16"	4600	310
H-ZCOFC16-16N	1	1"	0.87[22.10]	2.02[51.31]	1-5/8"	4400	300

### Соединитель с трубным фитингом Hy-Lok

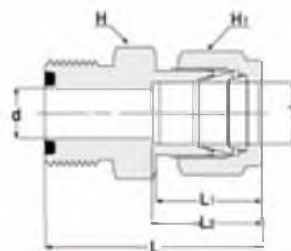

Part Number	ZCO Size In	T Tube O.D.	d	L	L <sub>1</sub>	L <sub>2</sub>	H Hex Flat	H <sub>1</sub> Hex Flat	Working Pressure	
									psig	bar
H-ZCOCC 4- 2	1/4	1/8"	0.09[ 2.29]	1.38[35.05]	0.60[15.24]	0.51[12.95]	5/8"	7/16"	10900	750
H-ZCOCC 4- 4	1/4	1/4"	0.18[ 4.57]	1.47[37.34]	0.70[17.78]	0.60[15.24]	5/8"	9/16"	10200	700
H-ZCOCC 8- 6	1/2	3/8"	0.28[ 7.11]	1.65[41.91]	0.76[19.30]	0.66[16.76]	15/16"	11/16"	6500	440
H-ZCOCC 8- 8	1/2	1/2"	0.40[10.16]	1.78[45.21]	0.87[22.10]	0.90[22.86]	15/16"	7/8"	6700	460
H-ZCOCC12-12	3/4	3/4"	0.62[15.75]	1.86[47.24]	0.87[22.10]	0.96[22.38]	1-5/16"	1-1/8"	5800	390
H-ZCOCC16-16	1	1"	0.87[22.10]	2.06[52.32]	1.04[26.42]	1.23[31.24]	1-5/8"	1-1/2"	4700	320

### Соединитель с фитингом Ну-Лок и креплением на панель

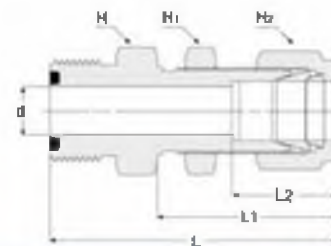

Part Number	ZCO Size in	T Tube O.D.	d	L	L <sub>1</sub>	L <sub>2</sub>	H Hex Flat	H <sub>1</sub> Hex Flat	H <sub>2</sub> Hex Flat	Panel Hole Size	Max. Panel Thickness	Working Pressure	
												psig	bar
H-ZCOCBHC 4-4	1/4	1/4"	0.18 { 4.57 }	2.10 { 53.34 }	1.32 { 33.53 }	0.60 { 15.24 }	5/8"	5/8"	9/16"	29/64"	0.40"	10200	700
H-ZCOCBHC 6-6	1/2	3/8"	0.28 { 7.11 }	2.34 { 59.44 }	1.45 { 36.83 }	0.66 { 16.76 }	15/16"	3/4"	11/16"	37/64"	0.44"	8500	440
H-ZCOCBHC 8-8	1/2	1/2"	0.40 { 10.16 }	2.55 { 64.77 }	1.65 { 41.91 }	0.90 { 22.86 }	15/16"	15/16"	7/8"	49/64"	0.50"	6700	460
H-ZCOCBHC 12-12	3/4	3/4"	0.62 { 15.75 }	2.86 { 72.50 }	1.87 { 47.50 }	0.96 { 24.38 }	1-5/16"	1-3/16"	1-1/8"	1-1/64"	0.66"	5800	390
H-ZCOCBHC 16-16	1	1"	0.87 { 22.10 }	3.29 { 83.57 }	2.26 { 57.40 }	1.23 { 31.24 }	1-5/8"	1-5/8"	1-1/2"	1-21/64"	0.75"	4700	320

### Соединитель равнопроходный

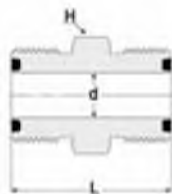

Part Number	ZCO Size in	d	L	H Hex Flat	Working Pressure	
					psig	bar
H-ZCOUA-4	1/4	0.18 { 4.57 }	1.25 { 31.75 }	5/8"	14300	980
H-ZCOUA-8	1/2	0.40 { 10.16 }	1.50 { 38.10 }	15/16"	11100	760

### Соединитель равнопроходный с креплением на панель

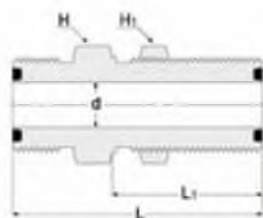

Part Number	ZCO Size in	D	d	L	H Hex Flat	H <sub>1</sub> Hex Flat	Panel Hole Size	Max. Panel Thickness	Working Pressure	
									psig	bar
H-ZCOBHU-4	1/4	1.06 { 26.92 }	0.18 { 4.57 }	1.88 { 47.75 }	3/4"	3/4"	37/64"	0.36"	14300	980
H-ZCOBHU-8	1/2	1.19 { 30.23 }	0.40 { 10.16 }	2.09 { 53.09 }	1-1/16"	1-1/16"	57/64"	0.40"	11100	760

### Соединитель понижающий

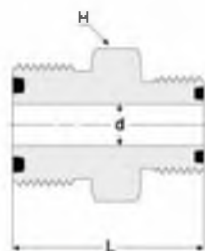

Part Number	ZCO Size in	ZCO Size in	d	L	H Hex Flat	Working Pressure	
						psig	bar
H-ZCOUR8-4	1/2	1/4	0.18 { 4.57 }	1.43 { 36.32 }	15/16"	11100	760

## Соединитель угловой с наружной резьбой NPT

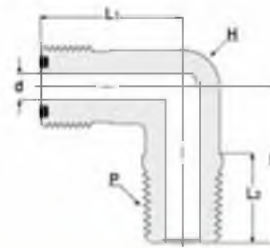

Part Number	ZCO Size in	P Male NPT Size	d	L	L <sub>1</sub>	L <sub>2</sub>	H Wrench Flat	Working Pressure	
								in. (mm)	
H-ZCOLM 4- 2N	1/4	1/8"	0.18 [ 4.57]	0.87 [22.10]	0.96 [24.38]	0.38 [ 9.65]	1/2"	10000	680
H-ZCOLM 4- 4N	1/4	1/4"	0.18 [ 4.57]	1.05 [26.67]	0.96 [24.38]	0.56 [14.22]	1/2"	8000	550
H-ZCOLM 8- 6N	1/2	3/8"	0.38 [ 9.65]	1.26 [32.00]	1.26 [32.00]	0.56 [14.22]	13/16"	7800	530
H-ZCOLM 8- 8N	1/2	1/2"	0.40 [10.16]	1.45 [36.83]	1.26 [32.00]	0.75 [19.05]	13/16"	7700	530
H-ZCOLM 12-12N	3/4	3/4"	0.62 [15.75]	1.67 [42.42]	1.48 [37.59]	0.75 [19.05]	1-1/4"	7300	500
H-ZCOLM 16-16N	1	1"	0.87 [22.10]	1.94 [49.28]	1.56 [39.62]	0.94 [23.88]	1-11/16"	5300	360

## Регулируемый угловой соединитель с резьбой SAE/MS

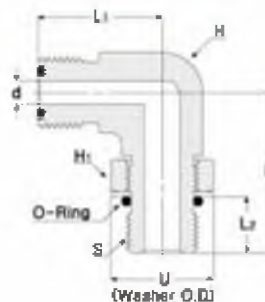

Part Number	ZCO Size in	S Straight Thread Size	d	L	L <sub>1</sub>	L <sub>2</sub>	H Wrench Flat	H <sub>1</sub> Hex Flat	O-ring Uniform size Number	U	Working Pressure	
											in. (mm)	
H-ZCOSL 4- 4U	1/4	7/16-20	0.18 [4.57]	1.19 [30.23]	0.96 [24.38]	0.39 [9.91]	5/8"	9/16"	-904	0.65"	4500	310
H-ZCOSL 8- 6U	1/2	9/16-18	0.30 [7.62]	1.54 [39.12]	1.33 [33.78]	0.44 [11.18]	1-1/16"	11/16"	-906	0.79"	3600	240
H-ZCOSL 8- 8U	1/2	3/4-16	0.40 [10.16]	1.65 [41.91]	1.33 [33.78]	0.50 [12.7]	1-1/16"	7/8"	-908	1.01"	3600	240
H-ZCOSL 12-12U	3/4	1-1/16-12	0.62 [15.75]	2.13 [54.10]	1.53 [38.86]	0.66 [16.76]	1-3/8"	1-1/4"	-912	1.44"	2900	190
H-ZCOSL 16-16U	1	1-5/16-12	0.87 [22.10]	2.31 [58.67]	1.72 [43.69]	0.66 [16.76]	1-11/16"	1-1/2"	-916	1.73"	2300	150

## Соединитель угловой

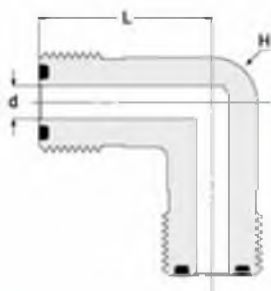

Part Number	ZCO Size in	d	L	H Wrench Flat	Working Pressure	
					in. (mm)	
H-ZCOLA- 4	1/4	0.18 [ 4.57]	0.96 [24.38]	1/2"	14300	980
H-ZCOLA- 8	1/2	0.40 [10.16]	1.26 [32.00]	13/16"	11100	760
H-ZCOLA-12	3/4	0.62 [15.75]	1.48 [37.59]	1-1/4"	10900	750
H-ZCOLA-16	1	0.87 [22.10]	1.56 [39.62]	1-11/16"	8800	600

Part Number	ZCO Size in	P Male NPT	In. (mm)				H Hex Flt	H <sub>1</sub> Hex Flt	O-ring Uniform size Number	Working Pressure	
			d	L	L <sub>1</sub>	L <sub>2</sub>				psig	Bar
H-ZCOSSMC 4- 4N	1/4	1/4"	0.181 (4.571)	1.591 (40.391)	0.561 (14.221)	0.721 (18.291)	9/16"	11/16"	-904	9800	670
H-ZCOSSMC 8- 6N	1/2	3/8"	0.401 (10.161)	1.671 (42.421)	0.561 (14.221)	0.781 (19.811)	11/16"	1"	-906	5600	390
H-ZCOSSMC 8- 8N	1/2	1/2"	0.401 (10.161)	1.871 (47.501)	0.751 (19.051)	0.791 (20.071)	7/8"	1"	-908	5600	390
H-ZCOSSMC12-12N	3/4	3/4"	0.621 (15.751)	2.031 (51.561)	0.751 (19.051)	0.941 (23.881)	1-1/16"	1-1/2"	-912	3900	260
H-ZCOSSMC16-16N	1	1"	0.871 (22.101)	2.341 (59.941)	0.941 (23.881)	0.981 (24.891)	1-3/16"	1-3/4"	-916	2900	190

### Адаптер с наружной резьбой SAE/MS

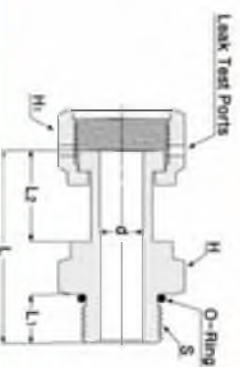

Part Number	ZCO Size in	S Straight Thread Size	In. (mm)				H Hex Flt	H <sub>1</sub> Hex Flt	O-ring Uniform size Number	Working Pressure	
			d	L	L <sub>1</sub>	L <sub>2</sub>				psig	Bar
H-ZCOSSC 4- 4U	1/4	7/16-20	0.181 (4.571)	1.541 (39.121)	0.361 (9.141)	0.771 (19.561)	9/16"	11/16"	-904	4500	310
H-ZCOSSC 8- 6U	1/2	9/16-18	0.401 (10.161)	1.641 (41.661)	0.391 (9.911)	0.811 (20.571)	11/16"	1"	-906	4500	310
H-ZCOSSC 8- 8U	1/2	3/4-16	0.401 (10.161)	1.711 (43.431)	0.441 (11.181)	0.811 (20.571)	7/8"	1"	-908	4500	310
H-ZCOSSC12-12U	3/4	1-1/16-12	0.621 (15.751)	2.071 (52.581)	0.581 (14.991)	0.941 (23.881)	1-1/4"	1-1/2"	-912	3600	240
H-ZCOSSC16-16U	1	1-5/16-12	0.871 (22.101)	2.171 (55.121)	0.591 (14.991)	0.981 (24.891)	1-1/2"	1-3/4"	-916	2900	190



HY-LOK CORPORATION

## Тройник

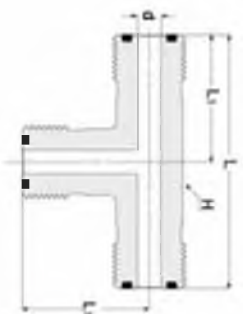

Part Number	ZCO Size In	In. [mm]			H Wrench Flat	Working Pressure psig Bar
		d	L	L <sub>1</sub>		
H-ZCOTA - 4	1/4	0.18 (4.57)	1.92 (48.79)	0.96 (24.38)	1/2"	14300 980
H-ZCOTA - 8	1/2	0.40 (10.16)	2.52 (64.00)	1.26 (32.00)	13/16"	11100 760
H-ZCOTA - 12	3/4	0.62 (15.75)	2.96 (75.18)	1.48 (37.59)	1-1/4"	10900 750
H-ZCOTA - 16	1	0.87 (22.10)	3.12 (79.25)	1.56 (39.62)	1-11/16"	8800 600

## Пробка



Part Number	ZCO Size In	L In. [mm]		H Hex Flat
		L	L <sub>1</sub>	
H-ZCOP - 4	1/4	0.77 (19.56)	0.47 (11.94)	5/8"
H-ZCOP - 8	1/2	0.89 (22.61)	0.56 (14.22)	15/16"
H-ZCOP - 12	3/4	0.99 (25.15)	0.56 (14.22)	1-5/16"
H-ZCOP - 16	1	1.02 (25.91)	0.56 (14.22)	1-5/8"

## Адаптер с наружной резьбой

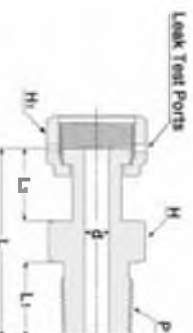



## Адаптер с внутренней резьбой

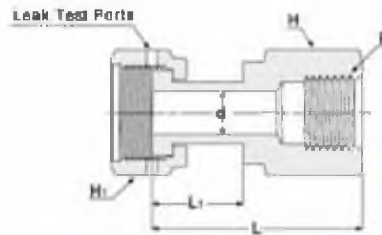

Part Number	ZCO Size in	P Female NPT Size	d	L	L <sub>1</sub>	H Hex Flt	H <sub>1</sub> Hex Flt	Working Pressure	
								psig	bar
H-ZCOSFC 4- 4N	1/4	1/4"	0.18 [ 4.57]	1.57 [39.88]	0.72 [18.29]	3/4"	1 1/16"	6600	450
H-ZCOSFC 8- 6N	1/2	3/8"	0.40 [10.16]	1.73 [43.94]	0.84 [21.34]	7/8"	1"	5300	360
H-ZCOSFC 8- 6N	1/2	1/2"	0.40 [10.16]	1.96 [49.78]	0.82 [20.83]	1-1/16"	1"	4900	330
H-ZCOSFC 12-12N	3/4	3/4"	0.62 [15.75]	2.12 [53.85]	0.94 [23.88]	1-5/16"	1-1/2"	4000	270
H-ZCOSFC 16-16N	1	1"	0.87 [22.10]	2.29 [58.17]	0.98 [24.89]	1-5/8"	1-3/4"	3000	200

## Адаптер соединитель

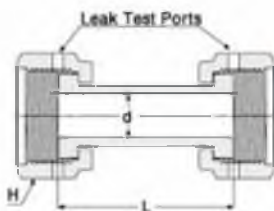

Part Number	ZCO Size in	d	L	H Wrench Flt	Working Pressure	
					psig	bar
H-ZCOSUA - 4	1/4	0.18 [ 4.57]	1.42 [36.07]	1 1/16"	10200	700
H-ZCOSUA - 8	1/2	0.40 [10.16]	1.61 [40.90]	1"	5800	390

## Инструкция по установке

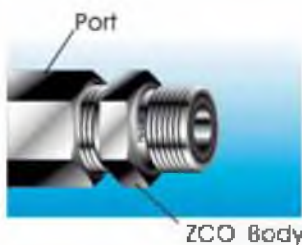

Установите корпус ZCO в существующий порт, трубку или оборудование

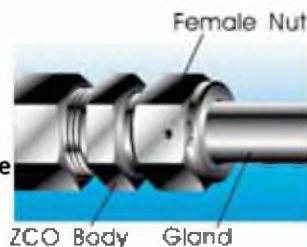

Наденьте на корпус ZCO гайку и вставку. Затяните соединение на 1/8 оборота до плотного стыка.

**Внимание:** Когда ZCO корпус или вставка нуждаются в сварке или пайке, необходимо временно снимать уплотнительное кольцо O-Ring во избежание его повреждения.

## Информация для заказа

Для корпусов, вставок и гаек используется обозначение S316, для чатей под автоматическую приварку используется обозначение 316L после оснвного заказного номера. Наприсер: H-ZCOSWG-4-316L

### По вопросам продаж и поддержки обращайтесь:

Архангельск +7 (8182) 45-71-35	Калининград +7 (4012) 72-21-36	Новороссийск +7 (8617) 30-82-64	Сочи +7 (862) 279-22-65
Астана +7 (7172) 69-68-15	Калуга +7 (4842) 33-35-03	Новосибирск +7 (383) 235-95-48	Ставрополь +7 (8652) 57-76-63
Астрахань +7 (8512) 99-46-80	Кемерово +7 (3842) 21-56-70	Омск +7 (381) 299-16-70	Сургут +7 (3462) 77-96-35
Барнаул +7 (3852) 37-96-76	Киров +7 (8332) 20-58-70	Орел +7 (4862) 22-23-86	Сызрань +7 (8464) 33-50-64
Белгород +7 (4722) 20-58-80	Краснодар +7 (861) 238-86-59	Оренбург +7 (3532) 48-64-35	Сыктывкар +7 (8212) 28-83-02
Брянск +7 (4832) 32-17-25	Красноярск +7 (391) 989-82-67	Пенза +7 (8412) 23-52-98	Тверь +7 (4822) 39-50-56
Владивосток +7 (4232) 49-26-85	Курск +7 (4712) 23-80-45	Первоуральск +7 (3439) 26-01-18	Томск +7 (3822) 48-95-05
Владимир +7 (4922) 49-51-33	Липецк +7 (4742) 20-01-75	Пермь +7 (342) 233-81-65	Тула +7 (4872) 44-05-30
Волгоград +7 (8442) 45-94-42	Магнитогорск +7 (3519) 51-02-81	Ростов-на-Дону +7 (863) 309-14-65	Тюмень +7 (3452) 56-94-75
Воронеж +7 (4732) 12-26-70	Москва +7 (499) 404-24-72	Рязань +7 (4912) 77-61-95	Ульяновск +7 (8422) 42-51-95
Екатеринбург +7 (343) 302-14-75	Мурманск +7 (8152) 65-52-70	Самара +7 (846) 219-28-25	Уфа +7 (347) 258-82-65
Иваново +7 (4932) 70-02-95	Наб.Челны +7 (8552) 91-01-32	Санкт-Петербург +7 (812) 660-57-09	Хабаровск +7 (421) 292-95-69
Ижевск +7 (3412) 20-90-75	Ниж.Новгород +7 (831) 200-34-65	Саранск +7 (8342) 22-95-16	Чебоксары +7 (8352) 28-50-89
Иркутск +7 (3952) 56-24-09	Нижевартовск +7 (3466) 48-22-23	Саратов +7 (845) 239-86-35	Челябинск +7 (351) 277-89-65
Йошкар-Ола +7 (8362) 38-66-61	Нижнекамск +7 (8555) 24-47-85	Смоленск +7 (4812) 51-55-32	Череповец +7 (8202) 49-07-18
Казань +7 (843) 207-19-05			Ярославль +7 (4852) 67-02-35

сайт: [hylok.pro-solution.ru](http://hylok.pro-solution.ru) | эл. почта: [hky@pro-solution.ru](mailto:hky@pro-solution.ru)  
телефон: 8 800 511 88 70